

Column 1

BLOCK MESH – PER 500' BUNDLE

- 4" x 10' Mill Galvanized Ladder or Truss
- 6" x 10' Mill Galvanized Ladder or Truss
- 8" x 10' Mill Galvanized Ladder or Truss
- 10" x 10' Mill Galvanized Ladder or Truss
- 12" x 10' Mill Galvanized Ladder or Truss

Other sizes and types available including Hot-Dipped and Hook & Eye

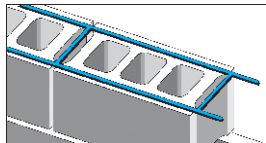

Ladder

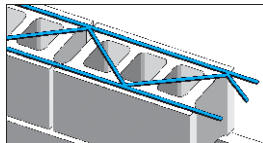

Truss

WALL TIES

- | | |
|----------------|-----------|
| 22 Ga. Regular | 500 / Box |
| 28 Ga. Regular | 500 / Box |

Hot-Dipped Galvanized also available

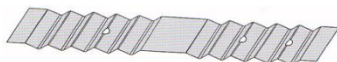

FIREBRICK

- | | | |
|----------------------|---------|--------------|
| 9" x 4 1/2" x 2 1/2" | Regular | 500 / Pallet |
| 9" x 4 1/2" x 1 1/4" | Splits | 850 / Pallet |



FIRE CLAY

50 lb Bag

MASON'S LIME

Mortaseal Mason's Lime 50# Bags

CLEAN OUT DOORS

- | | |
|----------|-----------|
| 8" x 8" | 10" x 12" |
| 8" x 10" | 12" x 12" |
| 8" x 12" | 12" x 16" |

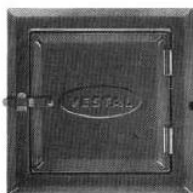

Available in Steel or Cast Iron

Column 2

METAL LATH

- (27" x 96" Sheets)
- 2.5 Galvanized
 - 2.5 Galvanized Paper Back
 - 2.5 Galvanized Self-Furring



Also Available in Offset and 3.4 Galv

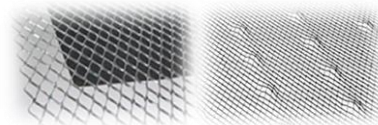

DRYWALL ACCESSORIES

- Corner Beads
- Resilient Channel
- Furring Channels
- Zinc Control Joint
- Casing Beads
- Corner Beads
- Mini-Bead
- Double "V" Expansion Joint

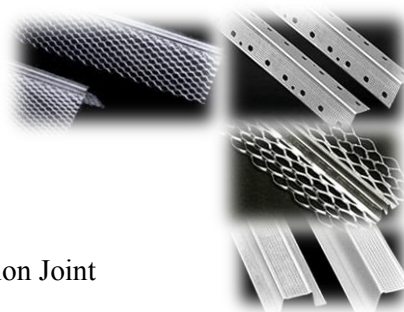

Other Accessories and information available

COLORINGS



Mortar Colors - SGS

- (12 Pkgs. Per Case)
- # 10-H Lite Buff
 - # 20-H Dark Buff
 - # 22-H Tan
 - # 33-H Brown
 - # 37-H Deep Brown
 - # 40-H Red
 - # 94-H Iron Black

Cement Colors - SGS

- (25# bags)
- # 413 Yellow Tone Red
 - # 415 Medium Tone Red
 - # 417 Blue Tone Red
 - # 425 Tracer Red
 - # 920 Black Iron Oxide

Additional colors Avail.

ANGLE IRON

				# per Foot
1"	x 1"	x 1/8"	x 20'	.80
2"	x 2"	x 1/4"	x 20'	3.19
3 1/2"	x 3 1/2"	x 1/4"	x 20'	5.80
5"	x 3 1/2"	x 5/16"	x 20'	8.70

Other sizes and lengths available

Available in Equal Leg Angles and Unequal Leg Angles

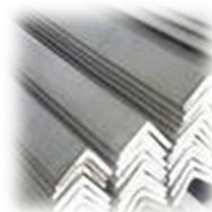

CONSOLIDATED
CONSTRUCTION
PRODUCTS, INC.

Andover, Ohio • Cuyahoga Falls, Ohio • London, Ohio • Walbridge, Ohio
Coraopolis, Pennsylvania • Mattawan, Michigan • Pendleton, Indiana • Carrollton, Kentucky

www.consolidatedconstructionproducts.com